

- ① HOUSING MATERIAL: THERMOPLASTIC.
- ② CONTACT MATERIAL: BERYLLIUM COPPER.
- ③ CONTACT FINISH: .000050-.000100 NICKEL UNDERPLATE ALL OVER WITH .000030 GOLD IN CONTACT AREA AND .000100-.000200 TIN-LEAD PLATED POSTS.

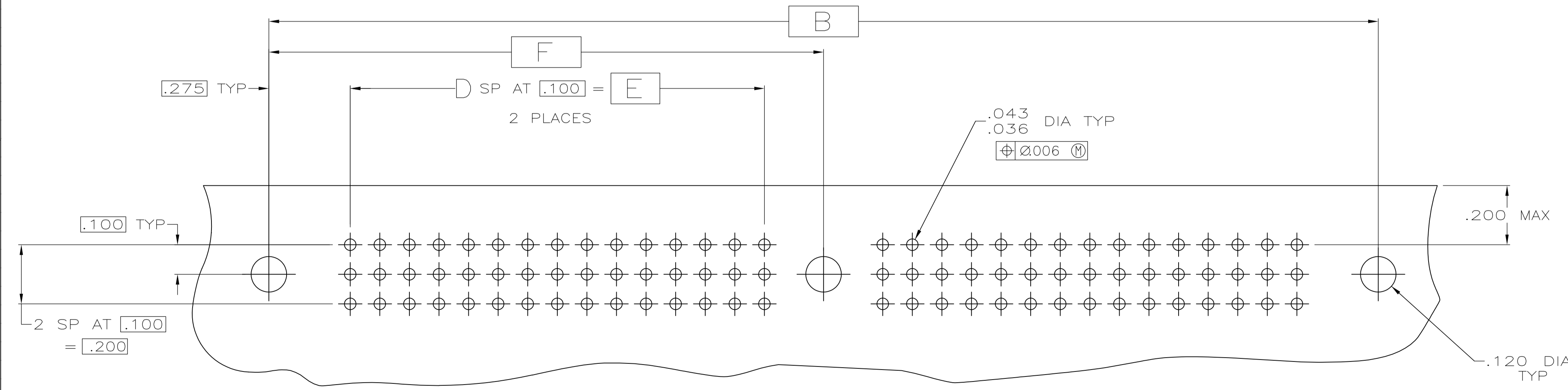
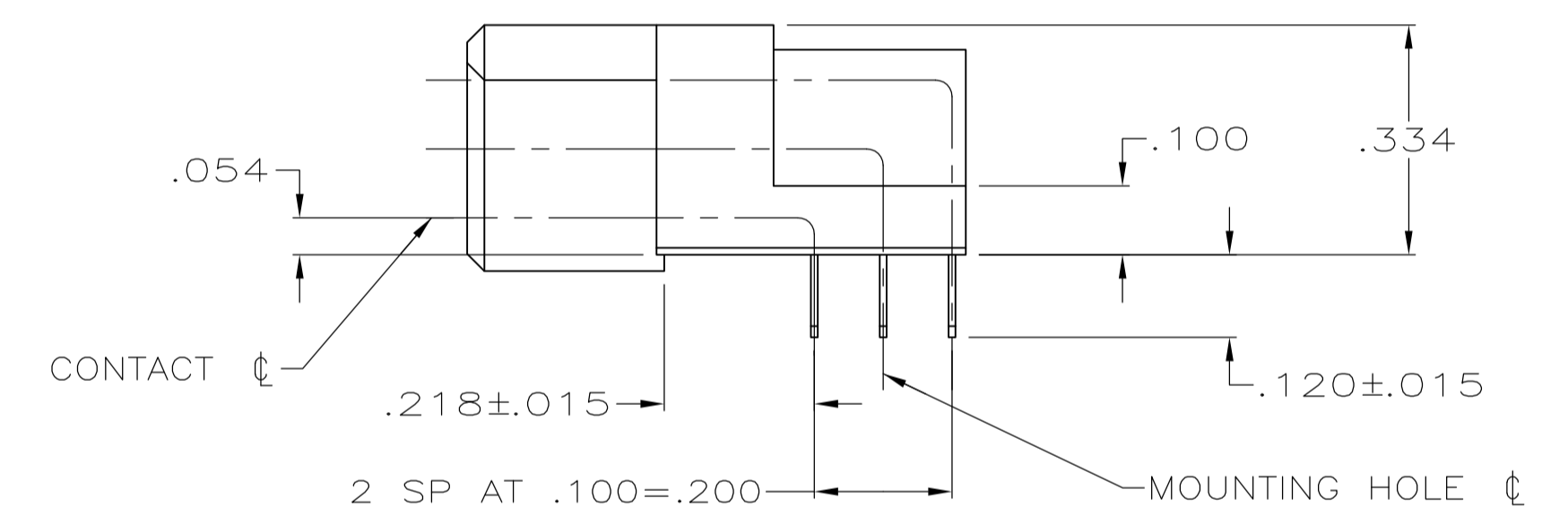
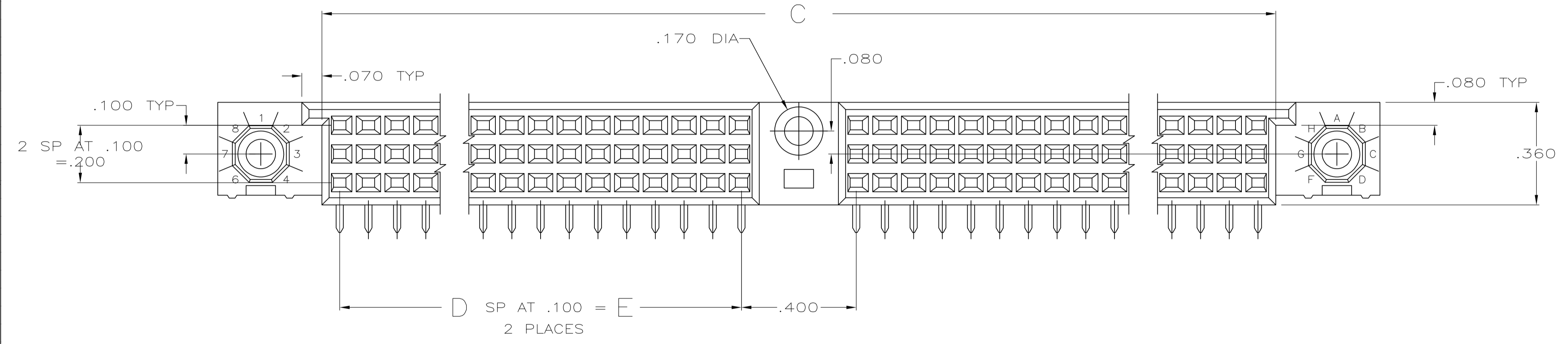
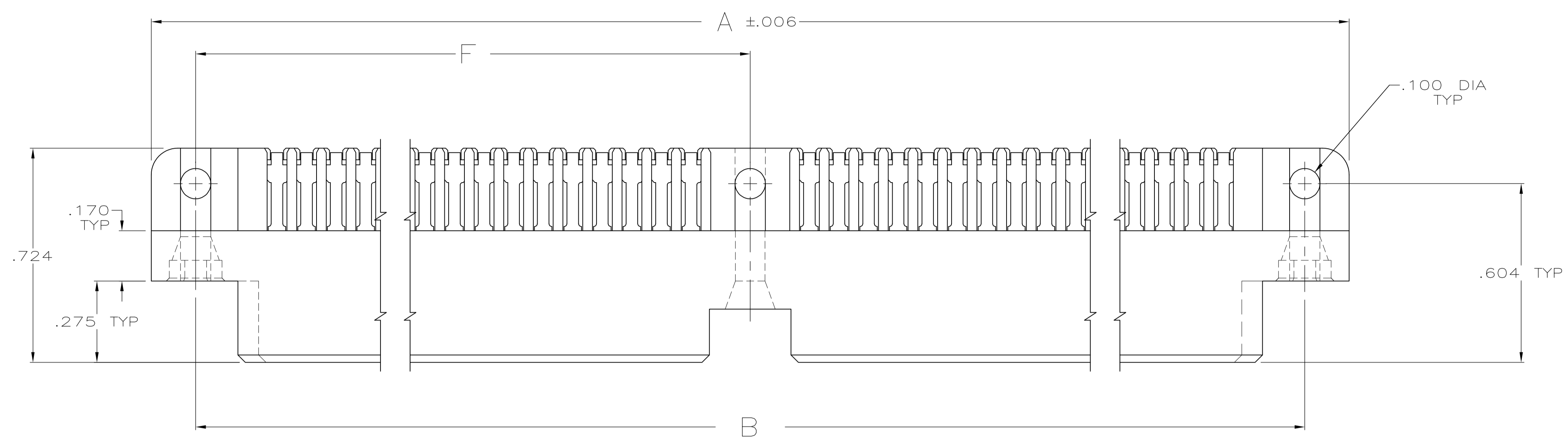

RECOMMENDED P.C. BOARD LAYOUT

OBSOLETE	6.475	6.000	60	12.524	12.950	13.250	366	534027-8
OBSOLETE	4.475	4.100	41	8.524	8.950	9.250	246	534027-7
OBSOLETE	6.375	5.900	59	12.324	12.750	13.050	360	534027-5
OBSOLETE	6.175	5.700	57	11.924	12.350	12.650	348	534027-4
OBSOLETE	5.575	5.100	51	10.724	11.150	11.450	312	534027-3
OBSOLETE	4.975	4.500	45	9.524	9.950	10.250	276	534027-2
	4.375	3.900	39	8.324	8.750	9.050	240	534027-1
	F	E	D	C	B	A	NO OF POSN	PART NUMBER

THIS DRAWING IS A CONTROLLED DOCUMENT.

DIMENSIONS: INCHES	TOLERANCES UNLESS OTHERWISE SPECIFIED:	0 PLC ± -	1 PLC ± -	2 PLC ± -	3 PLC ± .005	4 PLC ± -	ANGLES ± -
MATERIAL	FINISH	WEIGHT	SIZE	CAGE CODE	DRAWING NO	CUSTOMER DRAWING	
			A1	00779	534027	SCALE 4:1	SHEET 1 OF 1 REV G1

DAVID HOFFMAN
 ASSEMBLY, RECEPTACLE, TWIN BEAM CONNECTOR, 3 ROW, 108-1188
 2 MOUNTING HOLES, 1 GUIDE PIN, .120 POST LENGTH